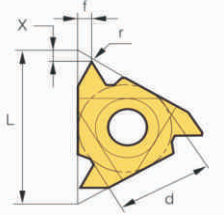
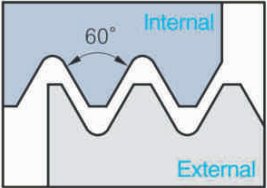

Partial profile
60° thread angle

Grade: TG3225

								(mm)
Type	Order No.	Pitch	Dimension (mm)					
			L	X	f	r	d	
External	16ERA60-TC	0.5-1.5	16	0.8	0.9	0.08	9.525	
	16ERAG60-TC	0.5-3.0	16	1.1	1.5	0.08	9.525	
	16ERG60-TC	1.75-3.0	16	1.2	1.7	0.25	9.525	
	22ERN60-TC	3.5-5.0	22	1.7	2.5	0.51	12.7	
Internal	11IRA60-TC	0.5-1.5	11	0.8	0.9	0.08	6.35	
	16IRA60-TC	0.5-1.5	16	0.8	0.9	0.08	9.525	
	16IRAG60-TC	0.5-3.0	16	1.1	1.5	0.08	9.525	
	16IRG60-TC	1.75-3.0	16	1.2	1.7	0.13	9.525	
	22IRN60-TC	3.5-5.0	22	1.7	2.5	0.25	12.7	

Partial profile
55° thread angle

Grade: TG3225

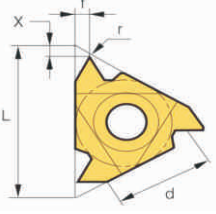
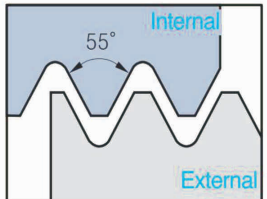
								(mm)
Type	Order No.	Pitch	Dimension (mm)					
			L	X	f	r	d	
External	16ERA55-TC	48-16	16	0.8	0.9	0.08	9.525	
	16ERAG55-TC	48-8	16	1.1	1.5	0.08	9.525	
	16ERG55-TC	14-8	16	1.2	1.7	0.21	9.525	
	22ERN55-TC	7-5	22	1.7	2.5	0.44	12.7	
Internal	11IRA55-TC	48-16	11	0.8	0.9	0.08	6.35	
	16IRA55-TC	48-16	16	0.8	0.9	0.08	9.525	
	16IRAG55-TC	48-8	16	1.1	1.5	0.08	9.525	
	16IRG55-TC	14-8	16	1.2	1.7	0.21	9.525	
	22IRN55-TC	7-5	22	1.7	2.5	0.44	12.7	

Full profile
ISO Metric

Grade: TG3225

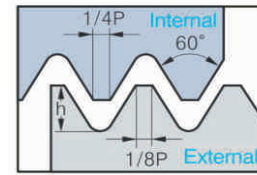
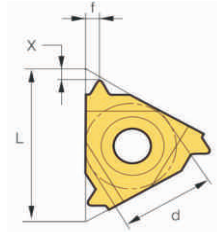

(mm)

Type	Order No.	Pitch	Dimension (mm)				
			L	X	f	r	d
External	16ER1.00ISO-TC	1	16	0.8	0.7	0.14	9.525
	16ER1.25ISO-TC	1.25	16	0.8	0.9	0.18	9.525
	16ER1.50ISO-TC	1.5	16	0.8	1	0.22	9.525
	16ER1.75ISO-TC	1.75	16	1.2	1.2	0.25	9.525
	16ER2.00ISO-TC	2	16	1.2	1.3	0.29	9.525
	16ER2.50ISO-TC	2.5	16	1.2	1.5	0.36	9.525
	16ER3.00ISO-TC	3	16	1.2	1.5	0.43	9.525
	22ER3.50ISO-TC	3.5	22	1.6	2.3	0.45	12.7
	22ER4.00ISO-TC	4	22	1.6	2.3	0.52	12.7
	22ER4.50ISO-TC	4.5	22	1.7	2.4	0.58	12.7
	22ER5.00ISO-TC	5	22	1.7	2.5	0.63	12.7
Internal	11IR1.00ISO-TC	1	11	0.8	0.7	0.07	6.35
	11IR1.25ISO-TC	1.25	11	0.8	0.9	0.09	6.35
	11IR1.50ISO-TC	1.5	11	0.8	1	0.11	6.35
	11IR1.75ISO-TC	1.75	11	0.9	1.1	0.13	6.35
	11IR2.00ISO-TC	2	11	0.9	1.1	0.15	6.35
	16IR1.00ISO-TC	1	16	0.8	0.7	0.07	9.525
	16IR1.25ISO-TC	1.25	16	0.8	0.9	0.09	9.525
	16IR1.50ISO-TC	1.5	16	0.8	1	0.11	9.525
	16IR1.75ISO-TC	1.75	16	1.2	1.2	0.13	9.525
	16IR2.00ISO-TC	2	16	1.2	1.3	0.15	9.525
	16IR2.50ISO-TC	2.5	16	1.2	1.5	0.18	9.525
	16IR3.00ISO-TC	3	16	1.2	1.5	0.22	9.525
	22IR3.50ISO-TC	3.5	22	1.6	2.3	0.22	12.7
	22IR4.00ISO-TC	4	22	1.6	2.3	0.25	12.7
	22IR4.50ISO-TC	4.5	22	1.6	2.4	0.28	12.7
	22IR5.00ISO-TC	5	22	1.6	2.3	0.32	12.7

Full profile
Unified

Grade: TG3225

				(mm)			
Type	Order No.	Pitch	Dimension (mm)				
			L	X	f	r	d
External	16ER24UN-TC	24	16	0.8	0.8	0.15	9.525
	16ER20UN-TC	20	16	0.8	0.9	0.18	9.525
	16ER18UN-TC	18	16	0.8	1	0.2	9.525
	16ER16UN-TC	16	16	0.9	1.1	0.23	9.525
	16ER14UN-TC	14	16	1.2	1.5	0.26	9.525
	16ER12UN-TC	12	16	1.2	1.5	0.31	9.525
	16ER10UN-TC	10	16	1.2	1.5	0.37	9.525
	16ER8UN-TC	8	16	1.3	1.7	0.46	9.525
Internal	11IR20UN-TC	20	11	0.8	0.9	0.09	6.35
	11IR18UN-TC	18	11	0.8	1	0.1	6.35
	16IR24UN-TC	24	16	0.8	0.8	0.08	9.525
	16IR20UN-TC	20	16	0.8	0.9	0.09	9.525
	16IR18UN-TC	18	16	0.8	1	0.1	9.525
	16IR16UN-TC	16	16	0.9	1.1	0.12	9.525
	16IR14UN-TC	14	16	1.2	1.5	0.13	9.525
	16IR12UN-TC	12	16	1.2	1.5	0.16	9.525
	16IR10UN-TC	10	16	1.2	1.5	0.19	9.525
	16IR8UN-TC	8	16	1.3	1.7	0.23	9.525

Full profile
Whitworth

Grade: TG3225

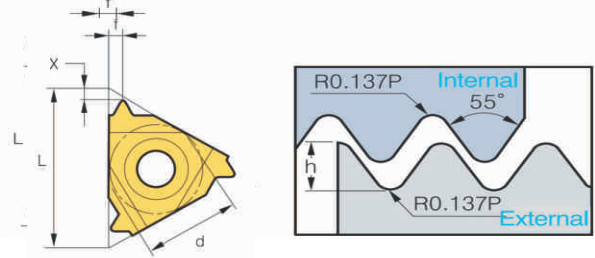
								(mm)
Type	Order No.	Pitch	Dimension (mm)					
			L	X	f	r	d	
External	16ER19W-TC	19	16	0.8	1	0.17	9.525	
	16ER14W-TC	14	16	1.2	1.5	0.24	9.525	
	16ER11W-TC	11	16	1.2	1.5	0.3	9.525	
Internal	16IR19W-TC	19	16	0.8	1	0.17	9.525	
	16IR14W-TC	14	16	1.2	1.5	0.24	9.525	
	16IR11W-TC	11	16	1.2	1.5	0.3	9.525	

External Threading Toolholders

SER
(Screw on system)

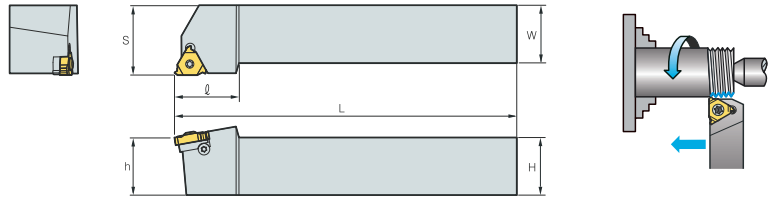

Righthand drawing
(mm)

Order No.	Dimension (mm)					Insert	Pin	Shim	Wrench	Screw
	H	W	S	L	h					
SER-1212H16	12	12	16	100	12	16ER..	M3.5*10	-	T15	-
SER-1616H16	16	16	20	100	16		M3.5*12	STM1603	T15 L2.5	M3*6N
SER-2020K16	20	20	25	125	20					
SER-2525M16	25	25	32	150	25					
SER-3232P16	32	32	40	170	32					
SER-2525M22	25	25	32	150	25	22ER..	M4*16	STM22T3	T20 L3	M4*8N
SER-3232P22	32	32	40	170	32					

Internal Threading Bars

SNR
(Screw on system)

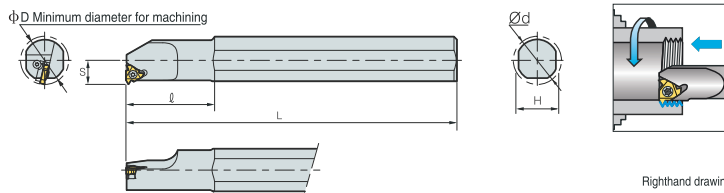

Righthand drawing

(mm)

Order No.	Dimension (mm)						Insert	Pin	Shim	Wrench	Screw
	D	d	L	S	H	I					
SNR-0008K11	11	8	125	5.5	7	20	11IR..	M2.5*6	-	T8	-
SNR-0010K11	13	10	125	6.5	9	22					
SNR-0012K11	15	12	125	7.5	11	26					
SNR-0016Q16	19	16	180	10	15	36	16IR..	M3.5*8	-	T15	-
SNR-0020R16	24	20	200	12	18	40					
SNR-0025S16	29	25	250	14.5	23	45					
SNR-0032T16	36	32	300	18.5	30	45					
SNR-0040T16	44	40	300	22	37	60					
SNR-0020R22	23	20	200	11.5	18	40	22IR..	M5*16	STM22T3	T20 L3	M4*8N
SNR-0025S22	31	25	250	16	23	45					
SNR-0032T22	38	32	300	19.5	30	45					
SNR-0040T22	46	40	300	24	37	60					

API tubing and casing round threading > Standard triangle series round threading inserts

External threading insert

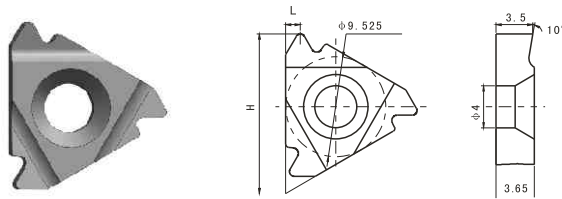

Ordering code	Teeth/inch	Taper	Thread form	H	L	Grade
16ER8AP I	8	1:16	API round tubing casing thread	15.2	1.4	0124 、 0326
16ER10AP I	10	1:16	API round tubing casing thread	15.2	1.2	0124 、 0326

Internal threading insert

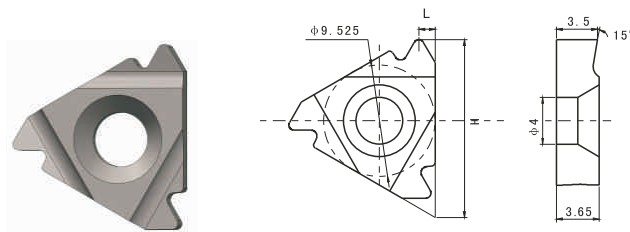

Ordering code	Teeth/inch	Taper	Thread form	H	L	Grade
16IR8AP I	8	1:16	API round tubing casing thread	15.2	1.4	0124 、 0326
16IR10AP I	10	1:16	API round tubing casing thread	15.2	1.2	0124 、 0326

API tubing and casing round threading > Papilionaceous series round threading inserts
External threading insert

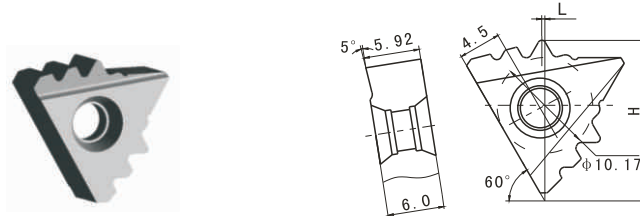

Ordering code	Teeth/inch	Taper	Thread form	H	L	Grade
B8W2-3(15°)	8	1:16	API round tubing thread	17.09	0.32	0124 、 0326
B8W2-3(12°)	8	1:16	API round casing thread	17.09	0.32	0124 、 0326
B10W2-4	10	1:16	API round tubing thread	17.09	0.32	0124 、 0326

Internal threading insert

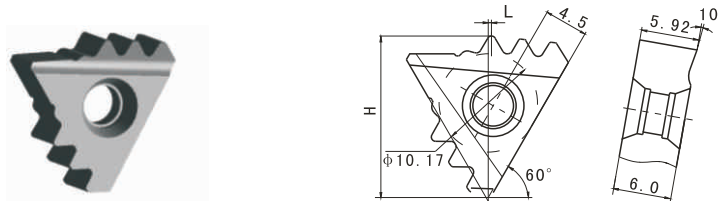

Ordering code	Teeth/inch	Taper	Thread form	H	L	Grade
B8N2-3	8	1:16	API round tubing casing thread	17.09	0.32	0124 、 0326
B10N2-4	10	1:16	API round tubing thread	17.09	0.01	0124 、 0326

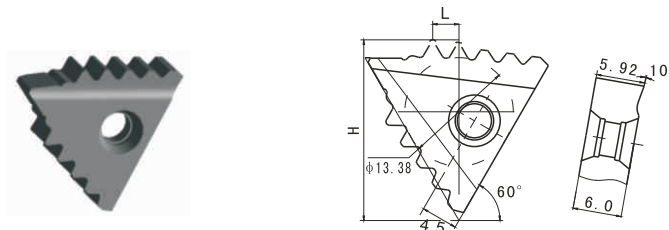

Ordering code	Teeth/inch	Taper	Thread form	H	L	Grade
B8N2-5	8	1:16	API round tubing casing thread	21.84	3.24	0124 、 0326

GOST buttress threading inserts for oil pipe

External threading insert

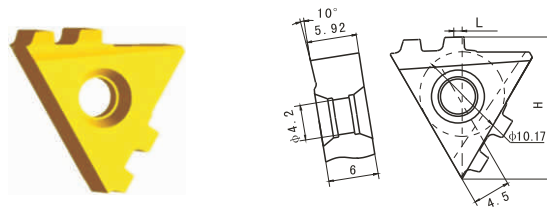

Ordering code	Teeth/inch	Taper	Thread form	H	L	Grade
E5BW2-2	5	1:16	OTTM 、 OTTG	17.03	0.83	0124 、 0326

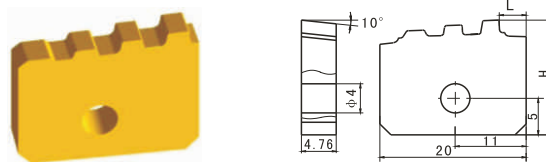

Ordering code	Teeth/inch	Taper	Thread form	H	L	Chipbreaker	Grade
E5BW1-31	5	1:16	OTTM 、 OTTG	15.70	3.64	BXCQW1-B II	0124 、 0326
E5BW1-32	5	1:16	OTTM 、 OTTG	15.88	1.0	BXCQW1-B II	0124 、 0326

GOST buttress threading inserts for oil pipe

Internal threading insert

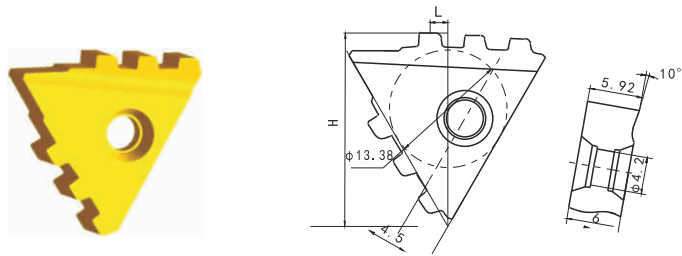

Ordering code	Teeth/inch	Taper	Thread form	H	L	Grade
E5BN2-3	5	1:16	OTTM 、 OTTG	22.075	2.0	0124 、 0326

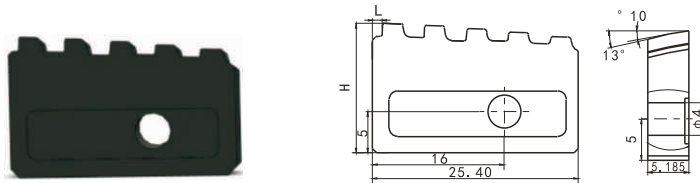

Ordering code	Teeth/inch	Taper	Thread form	H	L	Chipbreaker	Grade
E5BN1-5	5	1:16	OTTM 、 OTTG	15.736	1.2	TG3-1	0124 、 0326

Tool shank for papilionaceous round external threading inserts

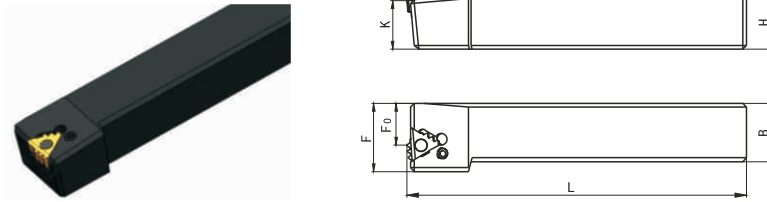

Type	Ordering code	Working range	Dimension							Machine tool
			L	H	K	B	F	F ₀	λ	
A	P10 (8) W2-A28×25	2 $\frac{3}{8}$ "~3 $\frac{1}{2}$ "	175	28	25	30	35	22	70'	G620
	P10 (8) W2-A35×32		175	35	32	35	40	27	70'	
	P10 (8) W2-A40×40		175	40	40	40	45	30	70'	
B	P10 (8) W2-B35×32	4"~5 $\frac{1}{2}$ "	175	35	32	35	40	27	50'	QK1312 Q1319
	P10 (8) W2-B40×40		175	40	40	40	45	30	50'	
C	P10 (8) W2-C35×32	6 $\frac{5}{8}$ "~8 $\frac{5}{8}$ "	175	35	32	35	40	27	30'	S1-344 S1-189
	P10 (8) W2-C40×40		175	40	40	40	45	30	30'	
D	P10 (8) W2-D35×32	9 $\frac{5}{8}$ "~13 $\frac{3}{8}$ "	175	35	32	35	40	27	15'	
	P10 (8) W2-D40×40		175	40	40	40	45	30	15'	

Accessory	Insert	Shim	Oblique rod	Lock screw	Wrench
Image					
Ordering code	B8W2-3H B10W2-4H	169. 798	φ4 Oblique rod	M6	S3

Square tool shank for papilionaceous round internal threading inserts

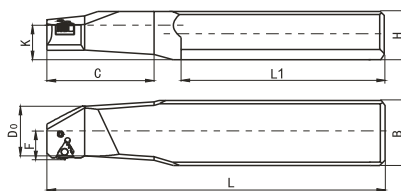

Type	Ordering code	Working range	Dimension									Machine tool
			L	L ₁	H	C	K	F	D ₀	B	λ	
A	P10 (8) N2-AS40×25	2 $\frac{3}{8}$ "~3 $\frac{1}{2}$ "	275	150	40	100	25	26	42	65	70'	C620
	P10 (8) N2-AS48×32		305	180	48	100	32	26	42	74	70'	QK1312 Q1319
	P10 (8) N2-AS48×32(A1)	2 $\frac{3}{8}$ "	265	140	48	85	32	26.5	45	74	70'	-
	P10 (8) N2-AS48×32(A2)	2 $\frac{7}{8}$ "~3 $\frac{1}{2}$ "	275	140	48	95	32	30.5	50	74	70'	-
B	P10 (8) N2-BS48×32	4"~5 $\frac{1}{2}$ "	335	180	48	130	32	31	50	74	50'	QK1312 Q1319
	P10 (8) N2-BS55×36		335	200	55	130	36	31	50	77	50'	S1-262 S1-245 QK1312 Q1319
C	P10 (8) N2-CS48×32	6 $\frac{5}{8}$ "~8 $\frac{5}{8}$ "	358	180	48	158	32	36	56	74	30'	S1-262 S1-245 QK1312 Q1319
	P10 (8) N2-CS55×36		378	200	55	158	36	36	56	77	30'	S1-262 S1-245
D	P10 (8) N2-DS55×36	9 $\frac{5}{8}$ "~13 $\frac{3}{8}$ "	395	200	55	175	36	43	60	81	15'	S1-262 S1-245

Accessory	Insert	Shim	Oblique rod	Lock screw	Wrench
Image					
Ordering code	B8N2-3H B10N2-4H	169. 523	Φ4 Oblique rod	M6	S3

Round tool shank for papilionaceous round internal threading inserts

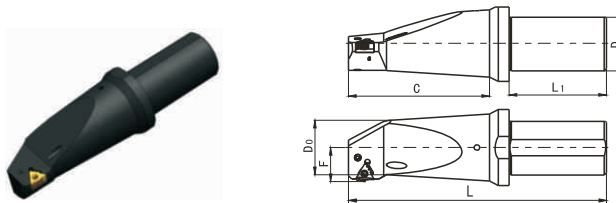

Type	Ordering code	Working range	Dimension							Machine tool
			L	L ₁	D	C	D ₀	F	λ	
A	P10 (8) N2-AR40×80	2 $\frac{3}{8}$ "~3 $\frac{1}{2}$ "	205	80	40	100	42	26	70'	CK7815 CK7620
	P10 (8) N2-AR50×90		215	90	50	100	42	26	70'	CK7832 CK3263A
	P10 (8) N2-AR60×100		225	100	60	100	42	26	70'	CK7840
	P10 (8) N2-AR80×140		265	140	80	100	42	26	70'	CK3263B
	P10 (8) N2-AR60×140 (A1)	2 $\frac{3}{8}$ "	265	140	60	85	45	26.5	70'	-
	P10 (8) N2-AR60×140 (A2)	2 $\frac{7}{8}$ "~3 $\frac{1}{2}$ "	275	140	60	95	50	30.5	70'	-
B	P10 (8) N2-BR40×80	4"~5 $\frac{1}{2}$ "	235	80	40	130	50	31	50'	CK7815 CK7620
	P10 (8) N2-BR50×90		245	90	50	130	50	31	50'	CK7832 CK3263A
	P10 (8) N2-BR60×100		255	100	60	130	50	31	50'	CK7840
	P10 (8) N2-BR80×140		295	140	80	130	50	31	50'	CK3263B
C	P10 (8) N2-CR50×90	6 $\frac{5}{8}$ "~8 $\frac{5}{8}$ "	268	90	50	158	56	36	30'	CK7840
	P10 (8) N2-CR60×100		278	100	60	158	56	36	30'	CK3263B
	P10 (8) N2-CR80×140		318	140	80	158	56	36	30'	CK7832 CK3263A
D	P10 (8) N2-DR60×100	9 $\frac{5}{8}$ "~13 $\frac{3}{8}$ "	295	100	60	175	60	43	15'	CK7840
	P10 (8) N2-DR80×140		335	140	80	175	60	43	15'	CK3263B

Accessory	Insert	Shim	Oblique rod	Lock screw	Wrench
Image					
Ordering code	B8N2-3H B10N2-4H	169. 523	Φ4 Oblique rod	M6	S3

Square tool shank for papilionaceous buttress internal threading inserts

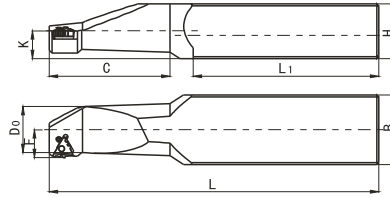

Type	Ordering code	Working range	Dimension									Machine tool
			L	L ₁	H	C	K	F	D ₀	B	λ	
B	P5BN2-BS48×32	4"~5 $\frac{1}{2}$ "	335	180	48	130	32	31	50	74	60'	S1-127 S1-344
	P5BN2-BS55×36		355	200	55	130	36	31	50	77	60'	
C	P5BN2-CS48×32	6 $\frac{5}{8}$ "~8 $\frac{5}{8}$ "	358	180	48	158	32	36	56	74	40'	S1-127 S1-344
	P5BN2-CS55×36		378	200	55	158	36	36	56	77	40'	
D	P5BN2-DS55×36	9 $\frac{5}{8}$ "~13 $\frac{3}{8}$ "	395	200	55	175	36	43	60	81	20'	S1-245 S1-262

Accessory	Insert	Shim	Oblique rod	Lock screw	Wrench
Image					
Ordering code	B5BN2-3	169.973	Φ4 Oblique rod	M6	S3

Round tool shank for papilionaceous buttress internal threading inserts

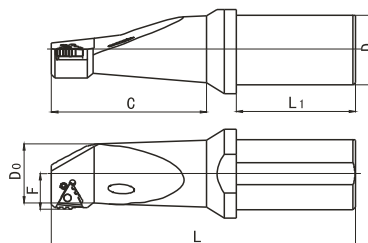

(mm)

Type	Ordering code	Working range	Dimension							Machine tool
			L	L ₁	D	C	D ₀	F	λ	
B	P5BN2-BR50×90	4 $\frac{1}{2}$ "~6 $\frac{5}{8}$ "	245	90	50	130	50	31	60'	CK7820 CK7832
	P5BN2-BR60×100		255	100	60	130	50	31	60'	CK7840 S1-181
	P5BN2-BR80×140		295	140	80	130	50	31	60'	CK3263
C	P5BN2-CR60×100	7"~11 $\frac{3}{4}$ "	283	100	60	158	56	36	40'	CK7820 CK7832
	P5BN2- CR80×140		323	140	80	158	56	36	40'	CK3263
D	P5BN2- DR60×100	13 $\frac{3}{8}$ "~20"	300	100	60	175	60	43	20'	CK7840 S1-181
	P5BN2- Dr80×140		340	140	80	175	60	43	20'	Ck3263

Accessory	Insert	Shim	Oblique rod	Lock screw	Wrench
Image					
Ordering code	B5BN2-3	169. 973	φ 4 Oblique rod	M6	S3

Tool shank for papilionaceous buttress external threading inserts

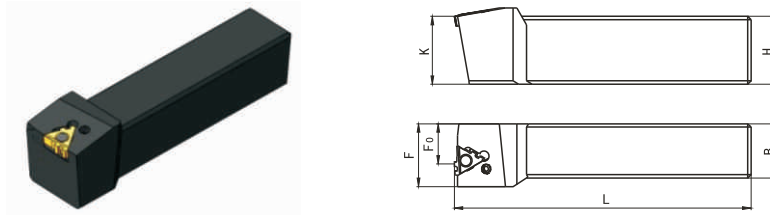

Type	Ordering code	Working range	Dimension							Machine tool
			L	H	K	B	F	F ₀	λ	
B	P5BW2-B35×32	4"~5 $\frac{1}{2}$ "	175	35	32	35	40	25	60'	QK1312 S1-245 S1-127
C	P5BW2-C35×32	6 $\frac{5}{8}$ "~8 $\frac{5}{8}$ "	175	35	32	35	40	25	40'	
D	P5BW2-D35×32	9 $\frac{5}{8}$ "~13 $\frac{3}{8}$ "	175	35	32	35	40	25	20'	

Accessory	Insert	Shim	Oblique rod	Lock screw	Wrench
Image					
Ordering code	B5BW2-2	169.798	φ4 Oblique rod	M6	S3